

Thank you for your purchase of our new SS3 2-Pod Frame. This frame allows you to mount two SS3 LED Pods together as one unit. Basic installation instructions are included below.

**Please contact us if you have any questions.**

**Tools Needed:** Screwdriver with T10 Torx Bit, Latex gloves (prevents fingerprints/grease on the lens)

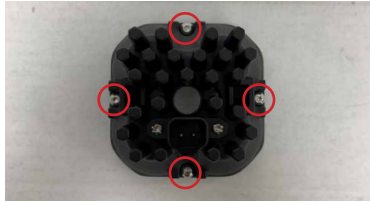
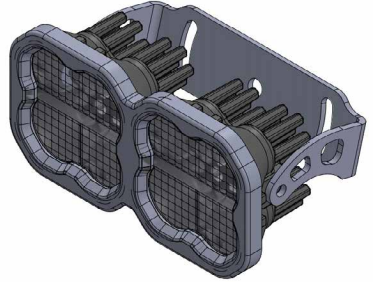

1. Remove the front bezel from the pod by placing the SS3 face down and removing the four T10 Torx screws. Repeat for the second pod.

**NOTE:** These screws won't be reused.



2. Place the 2-Pod Frame upside down on a flat surface. Wearing gloves, carefully remove the lens and o-ring from the SS3.



3. Place the lens and o-ring face down into the frame. Ensure the alignment notch on each lens is at the top of the frame.



4. Place the SS3 castings on top of the lenses.

**NOTE:** The DT-plug should be towards the bottom. The lens alignment notch will mate with the SS3 casting.

*See back for further instructions.*

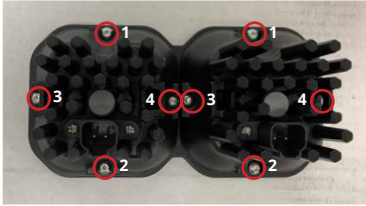

5. Using the T10 screws provided with the frame, tighten them in a “plus pattern” (top-bottom-left-right) to ensure the o-ring around the optic creates an even seal with the frame.



6. Place the included nuts in the outermost mounting points on each pod.

**NOTE:** The nylon portion of the nut should face inward.



7. Attach the U-bracket to the pods using the included screws and washers. Hand tighten only.



8. Mount the U-bracket to the vehicle using the supplied hardware. Adjust and aim the bracket. Then fully tighten the side bolts to complete the installation.

Refer to the Universal Bracket Info/Mounting Guide for wiring and specifications.

Please contact **Diode Dynamics** should you have any questions about the installation or wiring process, at **314-205-3033** (10a-5p CST) or **contact@diodedynamics.com**.

**This installation guide is for the following SKU:**

**DD6610** SS3 2-Pod Frame Kit

**100% SATISFACTION  
GUARANTEE**

