



FORD 2021-22 Bronco 3rd Brake Light Extension

Thank you for choosing Rough Country for all your vehicle needs.

Please read instructions before beginning installation. Check the kit hardware against the kit contents shown below. Be sure you have all needed parts and know where they go.

If question exist, please call us @1-800-222-7023. We will be happy to answer any questions concerning this product. Check all fasteners for proper torque. Check to ensure for adequate clearance between all components. Periodically check all hardware for tightness.

KIT CONTENTS:
3rd Brake Light Extension x1

TOOLS NEEDED:
T30 Torx Bit
10mm Wrench
4mm Allen Wrench

HARDWARE INCLUDED:
6mm x 20mm Button Head Bolts x2
6mm x 25mm Torx Head Screw x2
6mm Nylock Nuts x2
6mm Washers x2



Torque Specs:

Size	Grade 5	Grade 8	Size	Class 8.8	Class 10.9
5/16"	15 ft/lbs	20ft/lbs	6MM	5ft/lbs	9ft/lbs
3/8"	30 ft/lbs	35ft/lbs	8MM	18ft/lbs	23ft/lbs
7/16"	45 ft/lbs	60ft/lbs	10MM	32ft/lbs	45ft/lbs
1/2"	65 ft/lbs	90ft/lbs	12MM	55ft/lbs	75ft/lbs
9/16"	95 ft/lbs	130ft/lbs	14MM	85ft/lbs	120ft/lbs
5/8"	135ft/lbs	175ft/lbs	16MM	130ft/lbs	165ft/lbs
3/4"	185ft/lbs	280ft/lbs	18MM	170ft/lbs	240ft/lbs



INSTALLATION INSTRUCTONS

1. Remove the spare tire from the rear tire mount.
2. Remove the (4) bolts from the brake light mount using a T30 Torx bit. Retain hardware for reuse. **See Photo 1.**
3. Lift the brake light mount out of the tire carrier and place the brake light extension onto the light mount, secure using the (4) retained bolts. Tighten using a T30 Torx bit. **See Photo 2.**

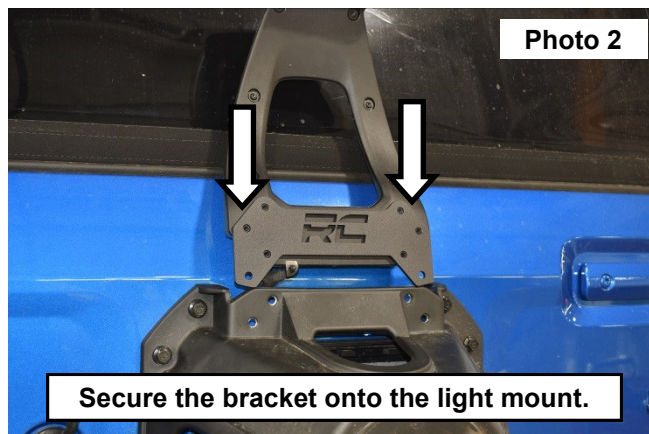
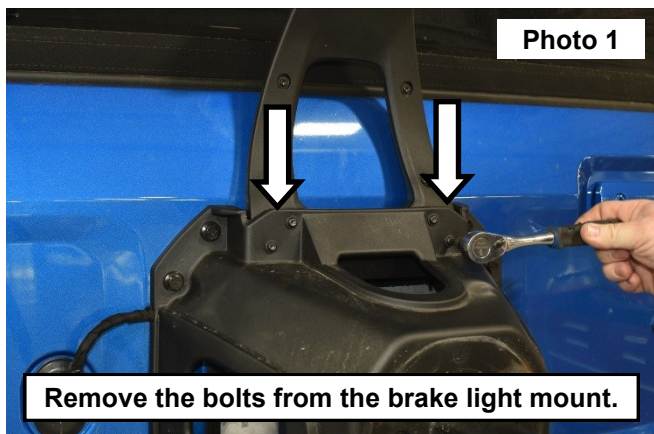

4. Place the light extension into the tire carrier mount centering up the mounting holes. **See Photo 3.**
5. Secure the upper mounting holes using (2) of the supplied 6mm x 25mm Torx head screw. Tighten using a T30 Torx bit. **See Photo 4.**



6. Secure the lower mounting holes using (2) supplied 6mm x 20mm button head bolts through the front of the mount. Secure the bolts on the back of the mount using (2) supplied 6mm flat washers and (2) 6mm Nylock nuts. **See Photo 5.**
7. Tighten using a 10mm wrench on the nut and a 4mm allen wrench on the bolt. **See Photo 6.**
8. Install the rear spare tire onto the carrier mount.

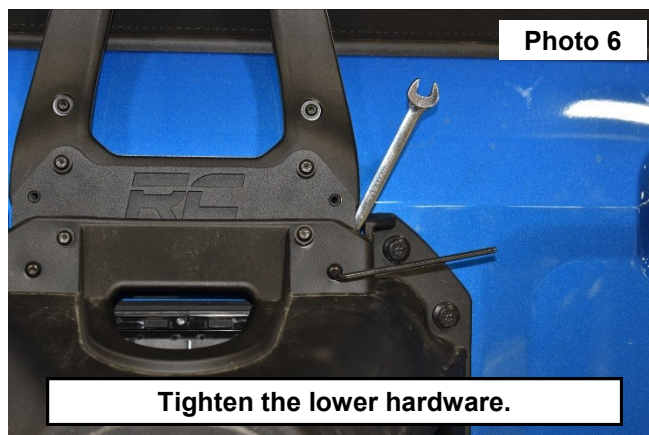
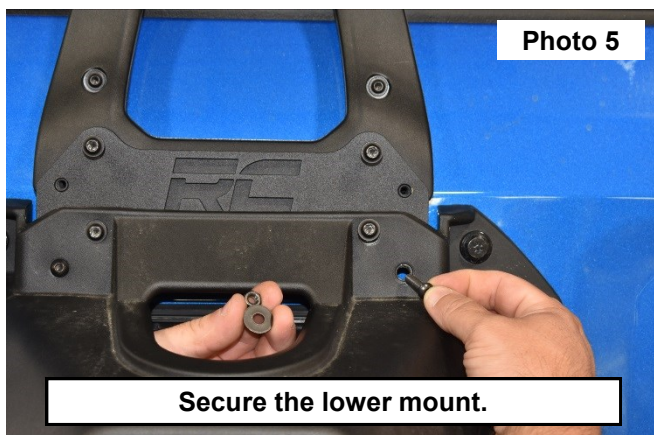

By purchasing any item sold by Rough Country, LLC, the buyer expressly warrants that he/she is in compliance with all applicable, State, and Local laws and regulations regarding the purchase, ownership, and use of the item. It shall be the buyers responsibility to comply with all Federal, State and Local laws governing the sales of any items listed, illustrated or sold. The buyer expressly agrees to indemnify and hold harmless Rough Country, LLC for all claims resulting directly or indirectly from the purchase, ownership, or use of the items.

